

Install Driver on raspberrypi via USB cable

Supported model list: Y813

NOTE: Applies to architecture aarch64

It takes a few minutes to show how to install FlashLabel Printer driver on raspberrypi via USB:

1. Please ensure printer is Turn OFF.
2. Connect printer to your computer via USB Cable.
3. Attach the power cable to power adapter, then connect the power cable to the printer, and plug it into the socket.
4. Turn ON printer.
5. Download Printer driver.
6. run "LabelPrinter-Linux-Driver-Latest_Ver1.1.1.run", follow below steps to install printer driver.

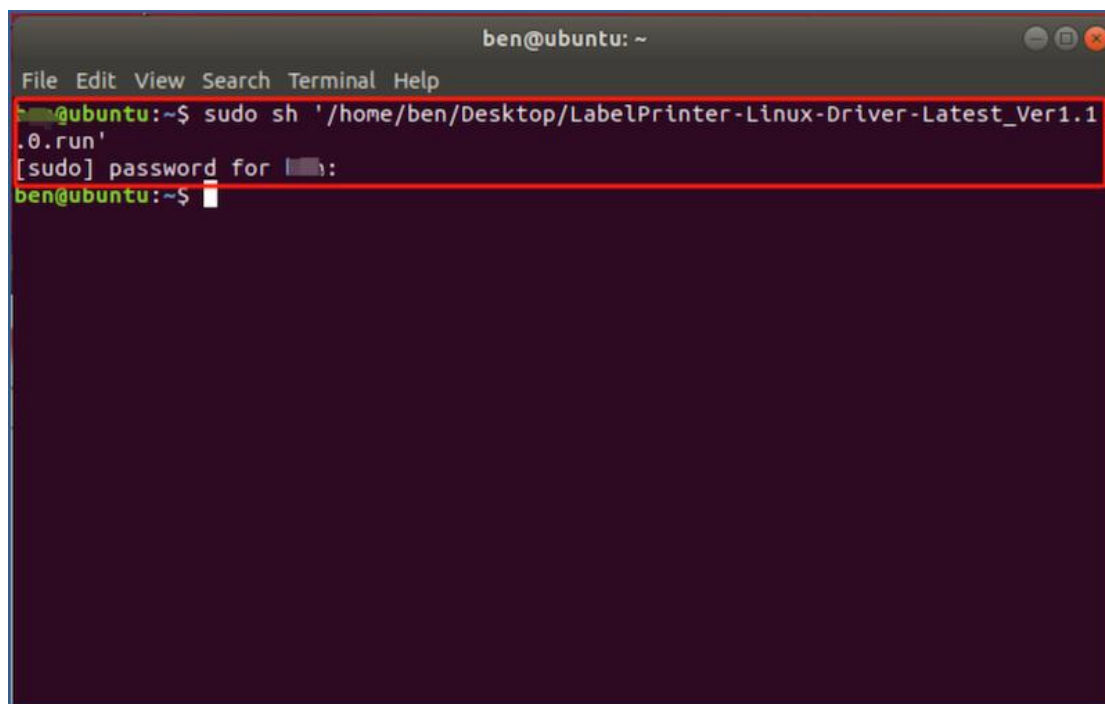

```
ben@ubuntu: ~  
File Edit View Search Terminal Help  
ben@ubuntu:~$ sudo sh '/home/ben/Desktop/LabelPrinter-Linux-Driver-Latest_Ver1.1.1.run'  
[sudo] password for ben:  
ben@ubuntu:~$
```

7. Follow below steps to Add printer.

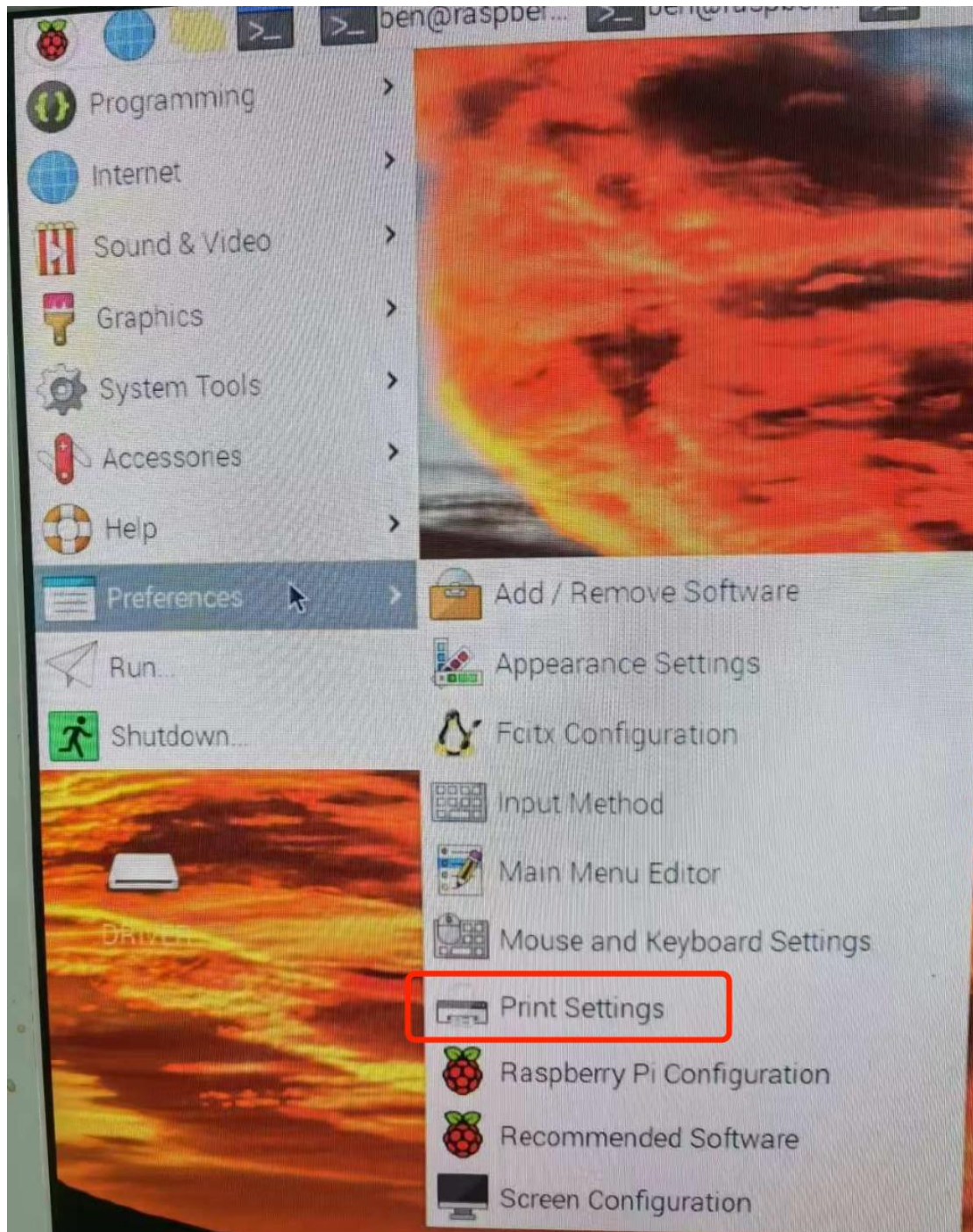

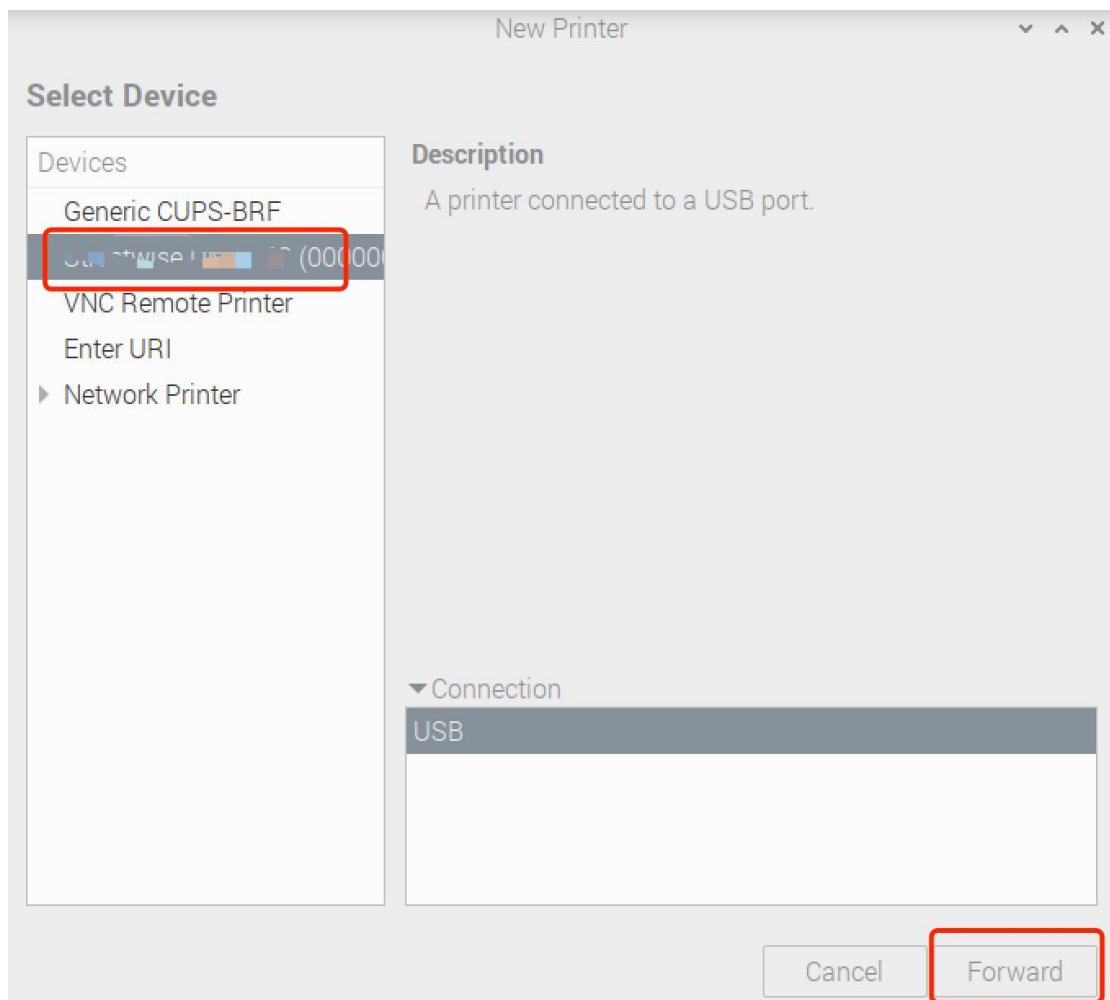
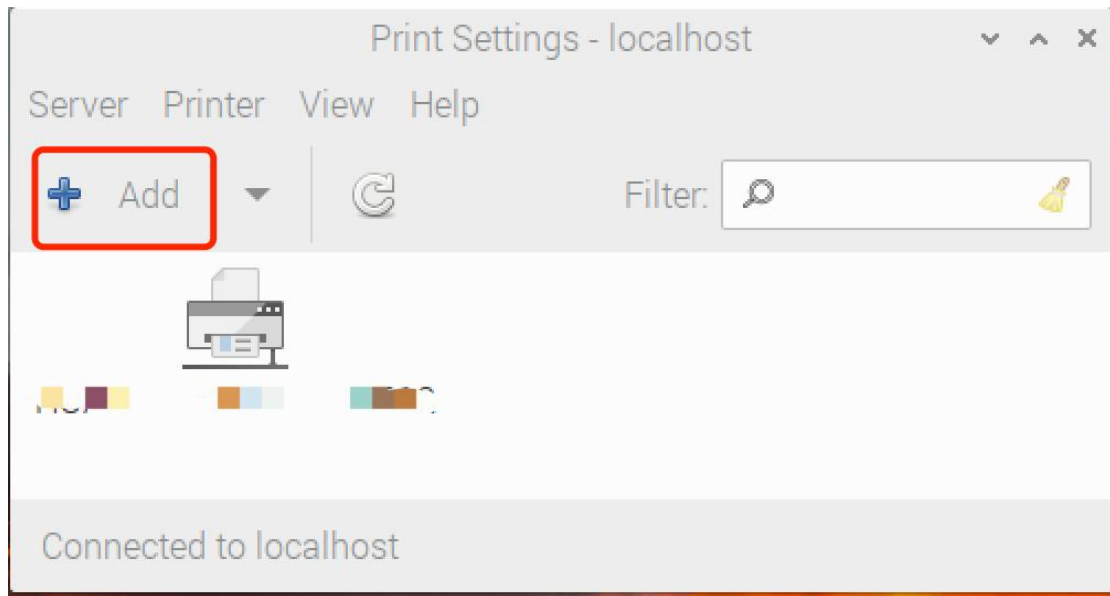

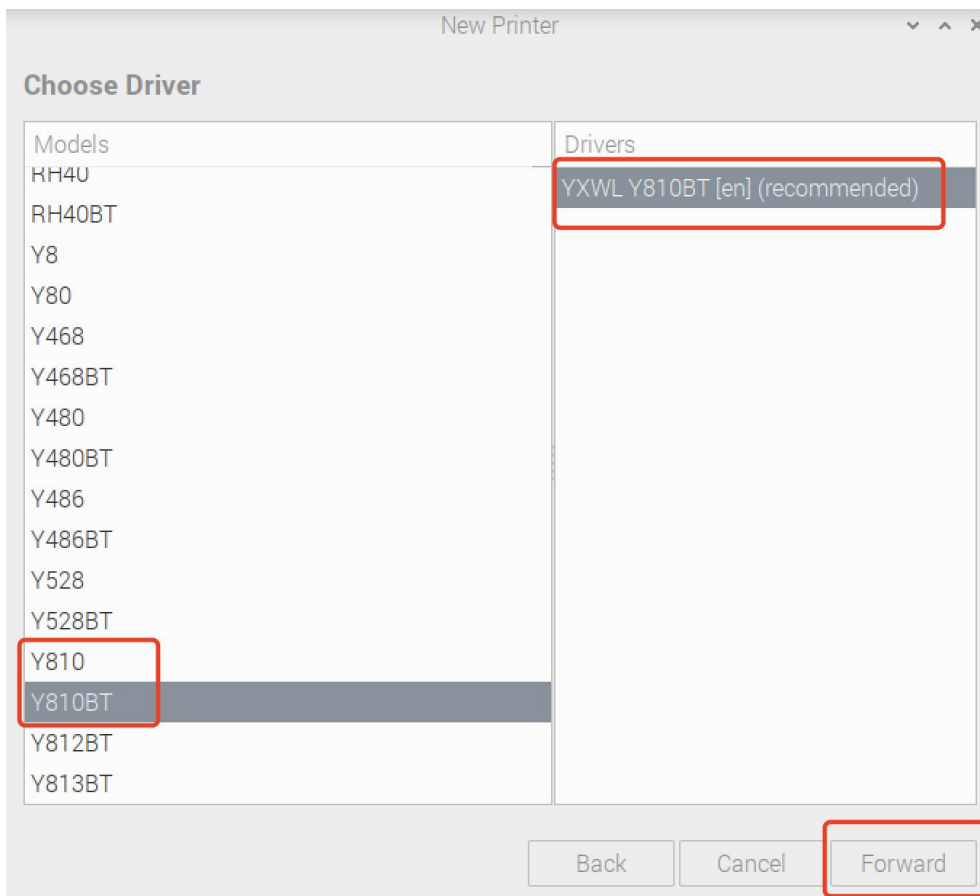
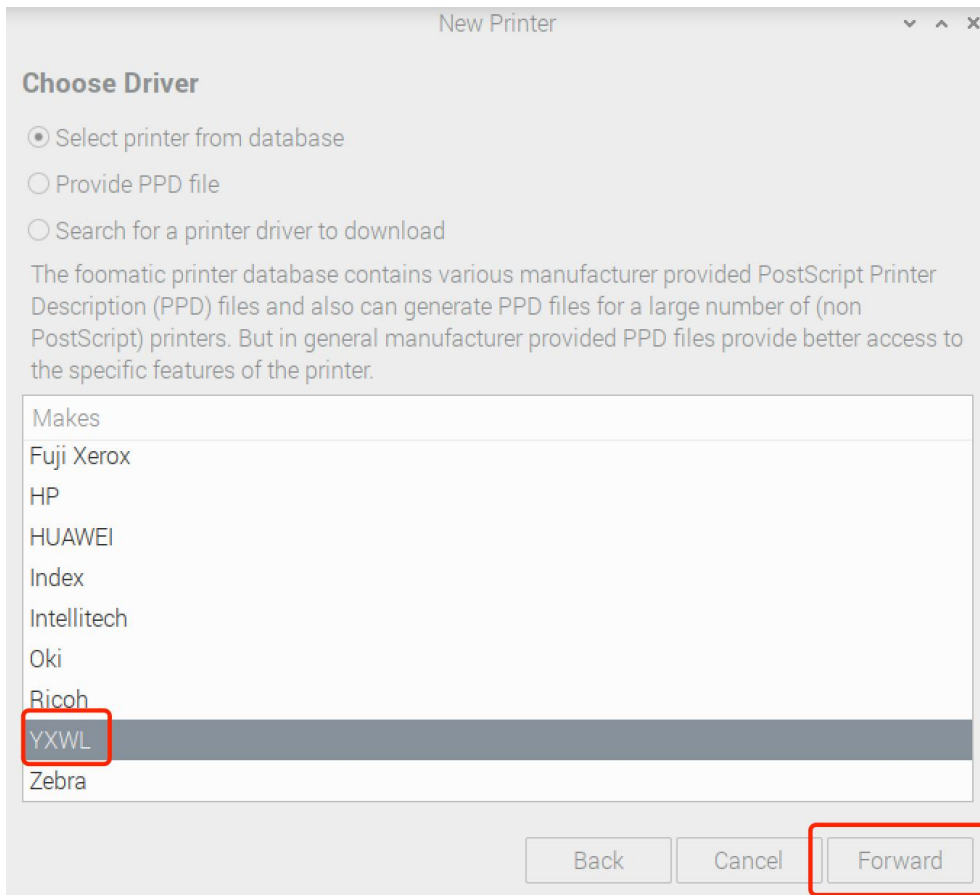

New Printer

Describe Printer

Printer Name
Short name for this printer such as "laserjet"

Description (optional)
Human-readable description such as "HP LaserJet with Duplexer"

Location (optional)
Human-readable location such as "Lab 1"

Back Cancel **Apply**

8. Enjoy your printing with FlashLabel Printer!